

Quick Smart Assembly!

IMPORTANT - Before setting-up your CLEV-A-Garden, it is suggested you position it on level ground to help with the assembly and efficient daily operation.

This is the most important part of assembly!

Both RED tie rods must be securely fitted as they are essential for locking the first 3 levels of your unit and the drip tray together to ensure the water tank fits correctly and securely.

What's in the box?

A new vertical, organic, self watering growing system! Remove the contents and follow the instructions 1 to 9 then start growing your favourite plants.

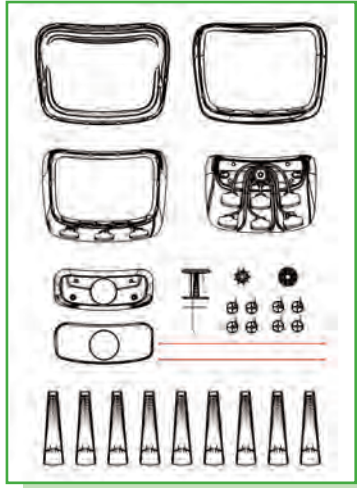

INSTRUCTIONS - Screwdriver needed

1. Locate drip tray, fit 8 snap-in wheels into holes provided in the base of drip tray as shown.
2. Clip the base shell into position in drip tray making sure its located properly in the slots in drip tray.
3. Locate both RED tie rods. Slot them into position on each side of the base of drip tray in key holes provided.
4. Clip the middle shell into position making sure that both RED tie rods stay in position.
5. Clip the top shell into position securely.
6. Place hand inside the unit and locate both RED tie rods. Pull each rod up into position in the roof of the top shell and push firmly outwards to lock as shown in **A** below.

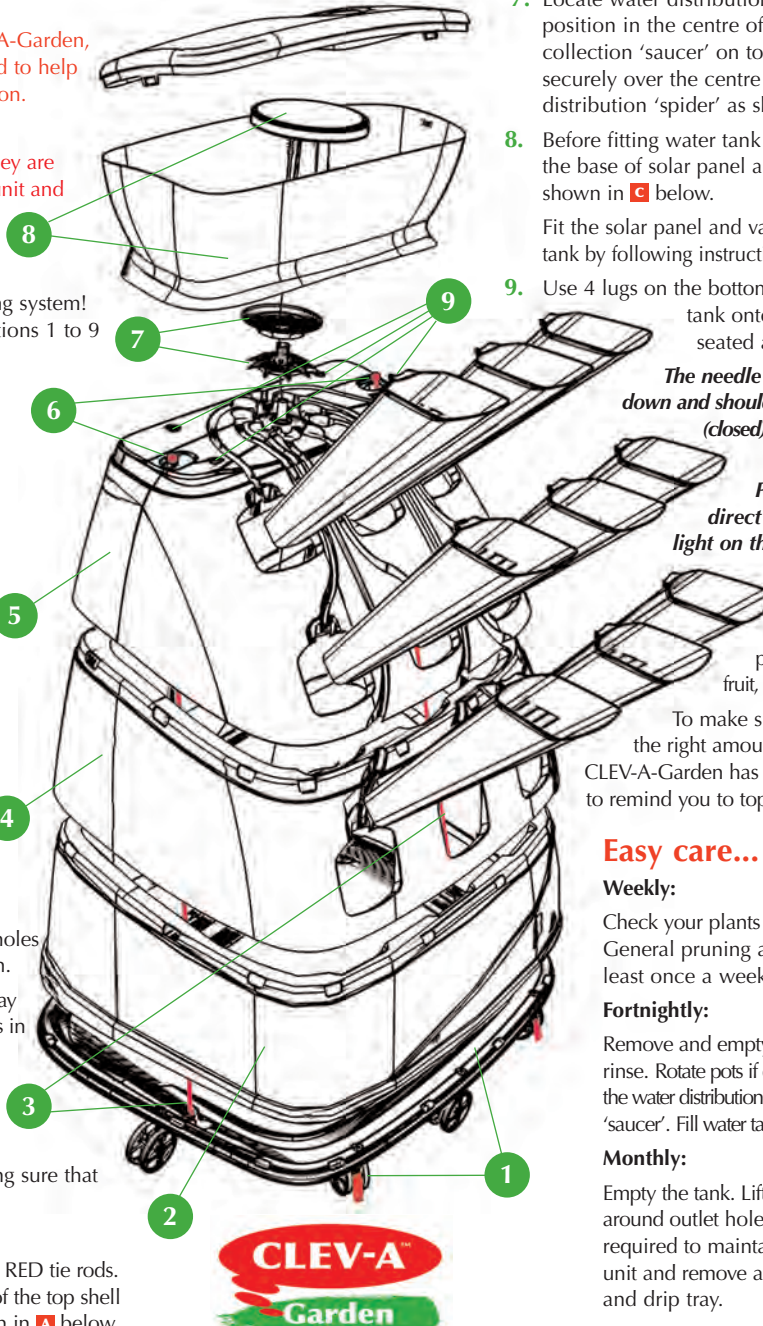

7. Locate water distribution 'spider' and place it in position in the centre of the top shell. Fit water collection 'saucer' on top of 'spider' making sure it fits securely over the centre hole and outer rim of water distribution 'spider' as shown in **B** below.
8. Before fitting water tank to the unit, fit 'O' ring over the base of solar panel and valve seat module as shown in **C** below.
Fit the solar panel and valve seat module to the water tank by following instructions in **D** below.
9. Use 4 lugs on the bottom of the water tank to fit the tank onto top shell. Push down until seated as shown in **E** and **F** below.

The needle valve must move freely up and down and should be left in the down position (closed) to seal the tank ready for filling.

Place your CLEV-A-Garden in direct light and leave until the LED light on the solar panel starts flashing... CLEV-A-Garden is now ready!

Fill the water tank, fit lid then simply fill all 9 pots and plant your perpetual vegetables, fruit, herbs, flowers, seeds or cuttings.

To make sure your plants always receive the right amount of water / nutrient everyday, CLEV-A-Garden has a low water level buzzer alarm to remind you to top-up the water tank!

Easy care... Handy tips!

Weekly:

Check your plants and top-up water level in tank. General pruning and plant care is required at least once a week.

Fortnightly:

Remove and empty tank completely, clean and rinse. Rotate pots if desired. Remove clean and rinse the water distribution 'spider' and water collection 'saucer'. Fill water tank and mix in 50ml of PowerFeed.

Monthly:

Empty the tank. Lift the needle valve and flush around outlet hole with fresh water... clean as required to maintain a good seal. Wipe face of unit and remove any debris from water channels and drip tray.

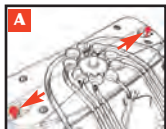

Snap the RED tie rods into position on both sides of the top shell by pushing the top shell down firmly and snapping the tie rods outwards to lock securely.

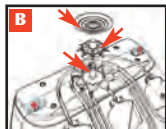

Fit water distribution 'spider' in centre of top shell. Fit collection 'saucer' on top of 'spider' making sure it fits securely over centre hole and outer rim of 'spider'.

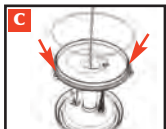

Locate solar panel and valve seat module. Fit 'O' ring over base of module making sure its seated evenly. Turn solar panel and valve seat module over and fit to base of tank.



Fit solar panel and valve seat module firmly into base of tank making sure the 3 screw holes line up and the needle valve is positioned at rear of tank. Screw module down with the 3 screws provided.

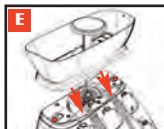

Fit tank to top shell by threading the DC power and temperature sensor cable through centre hole in collection 'saucer'. Push down firmly to secure water tank.

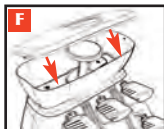

Fill tank with water. Fit lid over solar panel and close securely. Fill pots with organic earth, plant your favourite plants and reap healthy rewards.

Your CLEV-A-Garden is portable but care must be taken when moving it around particularly when water tank is full.

CLEV-A-Garden can be connected to low voltage DC power if required.

Uses solar power or a standard 5 volt DC power supply.

WARRANTY REGISTRATION

CLEV-A-Garden 9 Pot

Register your 12 Month Warranty now. From the date of purchase, your CLEV-A-Garden is covered by a 12 Month Warranty. Full terms and conditions are available on our website www.clevagarden.com Complete your information below and post to: CLEV-A-Garden Ltd, Suite 1, Commercial Centre, Balcarra, Western Australia 6021.

First Name _____ Surname _____

Telephone () _____ Mobile _____ Email _____

Address _____ Postcode _____

Place of purchase _____ Country _____ Purchase date _____

SAMPLE